

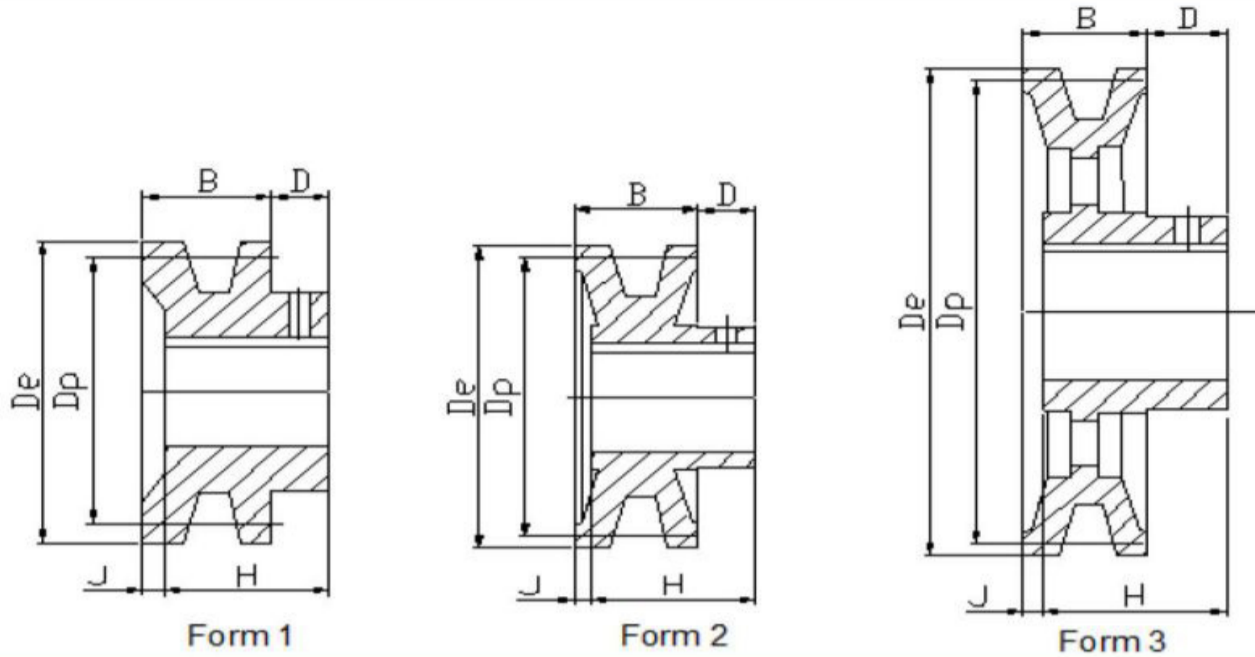

BORED TO SIZE SHEAVES

直孔皮带轮



for "4L" or "A" Belts and "3L" or "B" Belts
与"4L", "A"和"5L", "B"型号皮带配合使用

BK24 TO BK190

Table 3

(in)

| SIZE 规格 | Diameter | | | Form 型号 | Dimensions | | | | Stock Bores 孔径 |
|------------|----------|-------|-------|------------|------------|---------|-------|------|---|
| | De 外径 | Dp 节径 | | | B | H | D | J | |
| | | "A" | "B" | | | | | | |
| BK24 | 2.40 | 1.80 | 2.20 | 1 | 13/16 | 1 1/16 | 13/32 | 5/32 | 1/2,5/8,3/4 |
| BK25 | 2.50 | 1.90 | 2.30 | 1 | 13/16 | 1 1/16 | 13/32 | 5/32 | 1/2,5/8,3/4,7/8 |
| BK26 | 2.60 | 2.00 | 2.40 | 1 | 13/16 | 1 1/16 | 13/32 | 5/32 | 1/2,5/8,3/4,7/8 |
| BK27 | 2.70 | 2.10 | 2.50 | 2 | 13/16 | 1 1/16 | 13/32 | 5/32 | 1/2,5/8,3/4,7/8 |
| BK28 | 2.95 | 2.20 | 2.60 | 2 | 13/16 | 1 1/16 | 13/32 | 5/32 | 1/2,5/8,3/4,7/8 |
| BK30 | 3.15 | 2.40 | 2.80 | 2 | 13/16 | 1 1/16 | 13/32 | 5/32 | 1/2,5/8,3/4,7/8 |
| BK32 | 3.35 | 2.60 | 3.00 | 2 | 13/16 | 1 1/16 | 13/32 | 5/32 | 1/2,5/8,3/4,7/8 |
| BK34 | 3.55 | 2.80 | 3.20 | 2 | 7/8 | 1 5/32 | 13/32 | 1/8 | 1/2,5/8,3/4,7/8,1,1 1/8 |
| BK36 | 3.75 | 3.00 | 3.40 | 2 | 7/8 | 1 5/32 | 13/32 | 1/8 | 1/2,5/8,3/4,7/8,1,1 1/8 |
| BK40 | 3.95 | 3.20 | 3.60 | 2 | 7/8 | 1 5/32 | 13/32 | 1/8 | 1/2,5/8,3/4,7/8,1,1 1/8 |
| BK45 | 4.25 | 3.50 | 3.90 | 2 | 7/8 | 1 5/32 | 13/32 | 1/8 | 1/2,5/8,3/4,7/8,1,1 1/8 |
| BK47 | 4.45 | 3.70 | 4.10 | 2 | 7/8 | 1 5/32 | 13/32 | 1/8 | 1/2,5/8,3/4,7/8,1,1 1/8 |
| BK50 | 4.75 | 4.00 | 4.40 | 3 | 7/8 | 1 5/32 | 13/32 | 1/8 | 1/2,5/8,3/4,7/8,15/16,1,1 1/8 |
| BK52 | 4.95 | 4.20 | 4.60 | 3 | 7/8 | 1 5/32 | 13/32 | 1/8 | 1/2,5/8,3/4,7/8,1,1 1/8 |
| BK55 | 5.25 | 4.50 | 4.90 | 3 | 7/8 | 1 5/32 | 13/32 | 1/8 | 1/2,5/8,3/4,7/8,1,1 1/8,1 3/16 |
| BK57 | 5.45 | 4.70 | 5.10 | 3 | 7/8 | 1 5/32 | 13/32 | 1/8 | 5/8,3/4,7/8,15/16,1,1 1/8 |
| BK60 | 5.75 | 5.00 | 5.40 | 3 | 7/8 | 1 5/32 | 13/32 | 1/8 | 1/2,5/8,3/4,7/8,1,1 1/8,1 3/16 |
| BK62 | 5.95 | 5.20 | 5.60 | 3 | 7/8 | 1 5/32 | 13/32 | 1/8 | 1/2,5/8,3/4,7/8,15/16,1,1 1/8,1 3/16 |
| BK65 | 6.25 | 5.50 | 5.90 | 3 | 7/8 | 1 5/32 | 13/32 | 1/8 | 5/8,3/4,1,1 1/8 |
| BK67 | 6.45 | 5.70 | 6.10 | 3 | 7/8 | 1 5/32 | 13/32 | 1/8 | 5/8,3/4,1,1 1/8 |
| BK70 | 6.75 | 6.00 | 6.40 | 3 | 7/8 | 1 15/32 | 21/32 | 1/16 | 5/8,3/4,15/16,1,1 1/8,1 3/16,1 7/16 |
| BK72 | 6.95 | 6.20 | 6.60 | 3 | 7/8 | 1 15/32 | 21/32 | 1/16 | 3/4,1,1 1/8,1 3/8 |
| BK75 | 7.25 | 6.50 | 6.90 | 3 | 7/8 | 1 15/32 | 21/32 | 1/16 | 3/4,1,1 1/8,1 3/8 |
| BK77 | 7.45 | 6.70 | 7.10 | 3 | 7/8 | 1 15/32 | 21/32 | 1/16 | 3/4,1,1 1/8,1 3/8 |
| BK80 | 7.75 | 7.00 | 7.40 | 3 | 7/8 | 1 15/32 | 21/32 | 1/16 | 5/8,3/4,7/8,1,1 1/8,1 3/16,1 1/4,1 3/8,1 7/16 |
| BK85 | 8.25 | 7.50 | 7.90 | 3 | 7/8 | 1 15/32 | 21/32 | 1/16 | 3/4,1,1 1/8,1 3/8,1 7/16 |
| BK90 | 8.75 | 8.00 | 8.40 | 3 | 7/8 | 1 15/32 | 21/32 | 1/16 | 3/4,7/8,15/16,1,1 1/8,1 3/16,1 3/8,1 7/16 |
| BK95 | 9.25 | 8.50 | 8.90 | 3 | 7/8 | 1 15/32 | 21/32 | 1/16 | 3/4,1,1 1/8,1 3/8,1 7/16 |
| BK100 | 9.75 | 9.00 | 9.40 | 3 | 7/8 | 1 15/32 | 21/32 | 1/16 | 3/4,7/8,15/16,1,1 1/8,1 3/16,1 1/4,1 3/8,1 7/16 |
| BK105 | 10.25 | 9.50 | 9.90 | 3 | 7/8 | 1 15/32 | 21/32 | 1/16 | 1,1 3/8,1 7/16 |
| BK110 | 10.75 | 10.00 | 10.40 | 3 | 7/8 | 1 15/32 | 21/32 | 1/16 | 3/4,1,1 1/8,1 3/16,1 3/8,1 7/16 |
| BK115 | 11.25 | 10.50 | 10.90 | 3 | 7/8 | 1 15/32 | 21/32 | 1/16 | 1,1 3/8,1 7/16 |
| BK120 | 11.75 | 11.00 | 11.40 | 3 | 7/8 | 1 15/32 | 21/32 | 1/16 | 3/4,1,1 3/16,1 3/8,1 7/16 |
| BK130 | 12.75 | 12.00 | 12.40 | 3 | 7/8 | 1 15/32 | 21/32 | 1/16 | 3/4,1,1 1/8,1 3/16,1 1/4,1 7/16 |
| BK140 | 13.75 | 13.00 | 13.40 | 3 | 7/8 | 1 15/32 | 21/32 | 1/16 | 3/4,1,1 3/16,1 7/16 |
| BK160 | 15.75 | 15.00 | 15.40 | 3 | 7/8 | 1 15/32 | 21/32 | 1/16 | 1,1 1/8,1 3/16,1 1/4,1 7/16 |
| BK190 | 18.75 | 18.00 | 18.40 | 3 | 7/8 | 1 15/32 | 21/32 | 1/16 | 1,1 3/16,1 1/4,1 7/16 |



BORED TO SIZE SHEAVES

直孔皮带轮

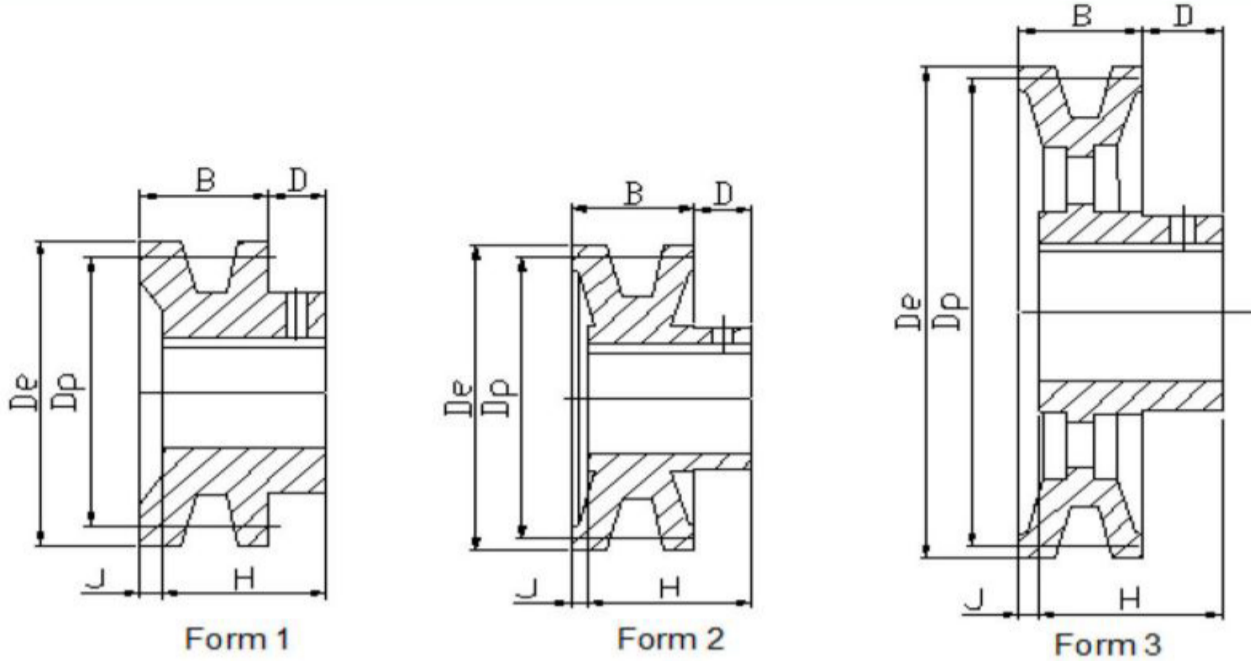

for "4L" or "A" Belts and "3L" Belts
与"4L","A"和"3L"型号皮带配合使用

AK17 TO AK184

Table 1

(in.)

| SIZE 规格 | Diameter | | | Form 型号 | Dimensions | | | | Stock Bores 孔径 |
|------------|----------|-------|-------|------------|------------|---------|-------|------|--|
| | De 外径 | Dp 节径 | | | B | H | D | J | |
| | | "A" | "3L" | | | | | | |
| AK17 | 1.75 | 1.50 | 1.16 | 1 | 21/32 | 15/16 | 7/16 | 5/32 | 1/2,5/8 |
| AK20 | 2 | 1.80 | 1.46 | 1 | 21/32 | 15/16 | 7/16 | 5/32 | 1/2,5/8,3/4 |
| AK21 | 2.1 | 1.90 | 1.56 | 1 | 21/32 | 15/16 | 7/16 | 5/32 | 1/2,5/8,3/4 |
| AK22 | 2.2 | 2.00 | 1.66 | 1 | 21/32 | 15/16 | 7/16 | 5/32 | 1/2,5/8,3/4 |
| AK23 | 2.3 | 2.10 | 1.76 | 1 | 21/32 | 15/16 | 7/16 | 5/32 | 1/2,5/8,3/4 |
| AK25 | 2.5 | 2.30 | 1.96 | 2 | 21/32 | 15/16 | 7/16 | 5/32 | 1/2,5/8,3/4 |
| AK26 | 2.6 | 2.40 | 2.06 | 2 | 21/32 | 15/16 | 7/16 | 5/32 | 1/2,5/8,3/4 |
| AK27 | 2.7 | 2.50 | 2.16 | 2 | 21/32 | 15/16 | 7/16 | 5/32 | 1/2,5/8,3/4 |
| AK28 | 2.8 | 2.60 | 2.26 | 2 | 21/32 | 15/16 | 7/16 | 5/32 | 1/2,5/8,3/4 |
| AK30 | 3.05 | 2.80 | 2.46 | 2 | 21/32 | 15/16 | 7/16 | 5/32 | 1/2,,5/8,3/4,7/8 |
| AK32 | 3.25 | 3.00 | 2.66 | 2 | 21/32 | 15/16 | 7/16 | 5/32 | 1/2,,5/8,3/4,7/8 |
| AK34 | 3.45 | 3.20 | 2.86 | 2 | 21/32 | 15/16 | 7/16 | 5/32 | 1/2,,5/8,3/4,7/8 |
| AK39 | 3.75 | 3.50 | 3.16 | 2 | 3/4 | 1 5/32 | 15/32 | 1/16 | 1/2,,5/8,3/4,7/8,15/16,1 |
| AK41 | 3.95 | 3.70 | 3.36 | 2 | 3/4 | 1 5/32 | 15/32 | 1/16 | 1/2,,5/8,3/4,7/8,15/16,1 |
| AK44 | 4.25 | 4.00 | 3.66 | 3 | 3/4 | 1 5/32 | 15/32 | 1/16 | 1/2,,5/8,3/4,7/8,15/16,1,1 1/8 |
| AK46 | 4.45 | 4.20 | 3.86 | 3 | 3/4 | 1 5/32 | 15/32 | 1/16 | 1/2,,5/8,3/4,7/8,15/16,1,1 1/8 |
| AK49 | 4.75 | 4.50 | 4.16 | 3 | 3/4 | 1 5/32 | 15/32 | 1/16 | 1/2,,5/8,3/4,7/8,15/16,1,1 1/8 |
| AK51 | 4.95 | 4.70 | 4.36 | 3 | 3/4 | 1 5/32 | 15/32 | 1/16 | 1/2,,5/8,3/4,7/8,1,1 1/8 |
| AK54 | 5.25 | 5.00 | 4.66 | 3 | 3/4 | 1 5/32 | 15/32 | 1/16 | 1/2,,5/8,3/4,7/8,15/16,1,1 1/8,1 3/16 |
| AK56 | 5.45 | 5.20 | 4.86 | 3 | 3/4 | 1 5/32 | 15/32 | 1/16 | 1/2,,5/8,3/4,7/8,15/16,1,1 1/8,1 3/16 |
| AK59 | 5.75 | 5.50 | 5.16 | 3 | 3/4 | 1 5/32 | 15/32 | 1/16 | 1/2,,5/8,3/4,7/8,15/16,1,1 1/8,1 3/16 |
| AK61 | 5.95 | 5.70 | 5.36 | 3 | 3/4 | 1 5/32 | 15/32 | 1/16 | 1/2,,5/8,3/4,7/8,15/16,1,1 1/8,1 3/16 |
| AK64 | 6.25 | 6.00 | 5.66 | 3 | 3/4 | 1 5/32 | 15/32 | 1/16 | 1/2,,5/8,3/4,7/8,15/16,1,1 1/8,1 3/16 |
| AK66 | 6.45 | 6.20 | 5.86 | 3 | 3/4 | 1 5/32 | 15/32 | 1/16 | 5/8,3/4,1,1 1/8 |
| AK69 | 6.75 | 6.50 | 6.16 | 3 | 3/4 | 1 15/32 | 23/32 | 0 | 3/4,1,1 1/8 |
| AK71 | 6.95 | 6.70 | 6.36 | 3 | 3/4 | 1 15/32 | 23/32 | 0 | 5/8,3/4,1,1 1/8,1 7/8 |
| AK74 | 7.25 | 7.00 | 6.66 | 3 | 3/4 | 1 15/32 | 23/32 | 0 | 1/2,5/8,3/4,15/16,1,1 1/8,1 3/16,1 1/4, 1 7/16 |
| AK79 | 7.75 | 7.50 | 7.16 | 3 | 3/4 | 1 15/32 | 23/32 | 0 | 3/4,1,1 1/8,1 7/16 |
| AK84 | 8.25 | 8.00 | 7.66 | 3 | 3/4 | 1 15/32 | 23/32 | 0 | 1/2,5/8,3/4,15/16,1,1 3/16,1 7/16 |
| AK89 | 8.75 | 8.50 | 8.16 | 3 | 3/4 | 1 15/32 | 23/32 | 0 | 3/4,1,1 1/8,1 7/16 |
| AK94 | 9.25 | 9.00 | 8.66 | 3 | 3/4 | 1 15/32 | 23/32 | 0 | 1/2,5/8,3/4,15/16,1,1 3/16,1 1/4,1 7/16 |
| AK99 | 9.75 | 9.50 | 9.16 | 3 | 3/4 | 1 15/32 | 23/32 | 0 | 3/4,1,1 7/16 |
| AK104 | 10.25 | 10.00 | 9.66 | 3 | 3/4 | 1 15/32 | 23/32 | 0 | 5/8,3/4,1,1 3/16,1 1/4,1 3/8,1 7/16 |
| AK109 | 10.75 | 10.50 | 10.16 | 3 | 3/4 | 1 15/32 | 23/32 | 0 | 3/4,1,1 3/8,1 7/16 |
| AK114 | 11.25 | 11.00 | 10.66 | 3 | 3/4 | 1 15/32 | 23/32 | 0 | 3/4,1,1 3/16,1 7/16 |
| AK124 | 12.25 | 12.00 | 11.66 | 3 | 3/4 | 1 15/32 | 23/32 | 0 | 5/8,3/4,1,1 3/16,1 1/4,1 7/16 |
| AK134 | 13.25 | 13.00 | 12.66 | 3 | 3/4 | 1 15/32 | 23/32 | 0 | 3/4,1,1 3/16,1 3/8,1 7/16 |
| AK144 | 14.25 | 14.00 | 13.66 | 3 | 3/4 | 1 15/32 | 23/32 | 0 | 3/4,1,1 3/16,1 7/16 |
| AK154 | 15.25 | 15.00 | 14.66 | 3 | 3/4 | 1 15/32 | 23/32 | 0 | 3/4,1,1 3/16,1 3/8,1 7/16 |
| AK184 | 18.25 | 18.00 | 17.66 | 3 | 3/4 | 1 15/32 | 23/32 | 0 | 3/4,1,1 3/16,1 7/16 |



BORED TO SIZE SHEAVES

直孔皮带轮

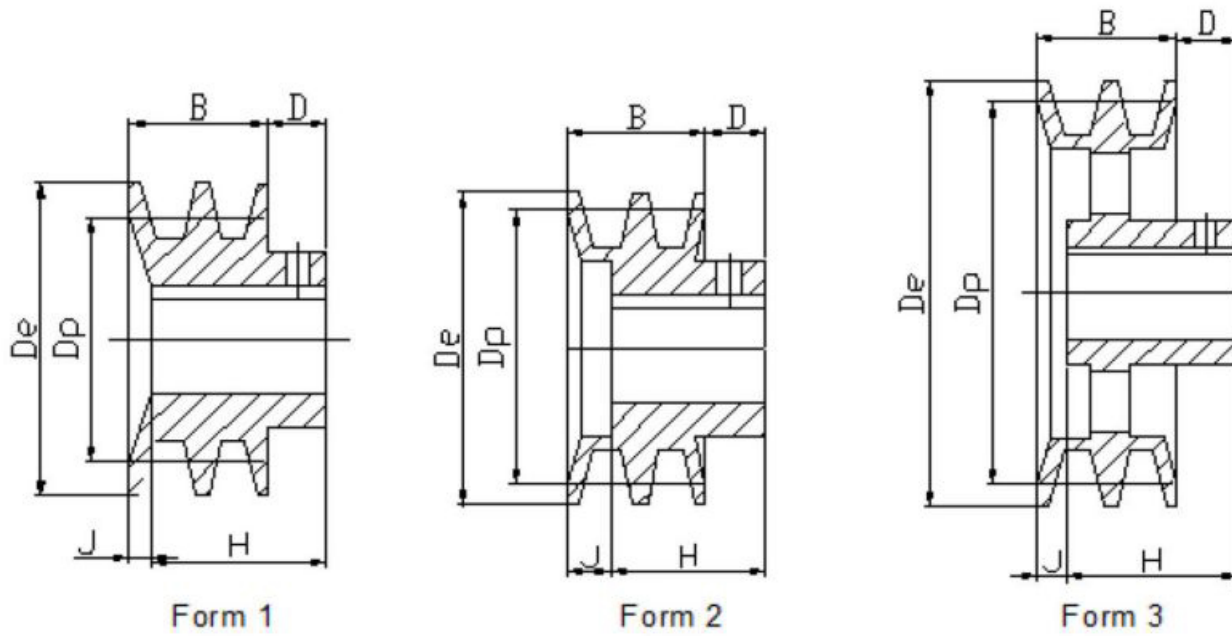

for "4L" or "A" Belts and "3L" Belts
与"4L","A"和"3L"型号皮带配合使用

2AK20 TO 2AK184

Table 2

(in.)

| SIZE 规格 | Diameter | | | Form 型号 | Dimensions | | | | Stock Bores 孔径 |
|------------|----------|-------|-------|------------|------------|---------|-------|------|---|
| | De 外径 | Dp 节径 | | | B | H | D | J | |
| | | "A" | "3L" | | | | | | |
| 2AK20 | 2.00 | 1.80 | 1.46 | 1 | 1 3/8 | 1 21/32 | 15/32 | 3/16 | 1/2, 5/8, 3/4 |
| 2AK21 | 2.15 | 1.90 | 1.56 | 1 | 1 3/8 | 1 21/32 | 15/32 | 3/16 | 1/2, 5/8, 3/4 |
| 2AK22 | 2.25 | 2.00 | 1.66 | 1 | 1 3/8 | 1 21/32 | 15/32 | 3/16 | 1/2, 5/8, 3/4, 7/8 |
| 2AK23 | 2.35 | 2.10 | 1.76 | 1 | 1 3/8 | 1 21/32 | 15/32 | 3/16 | 5/8, 3/4, 7/8, 1 |
| 2AK25 | 2.55 | 2.30 | 1.96 | 1 | 1 3/8 | 1 21/32 | 15/32 | 3/16 | 5/8, 3/4, 7/8, 1 |
| 2AK26 | 2.65 | 2.40 | 2.06 | 1 | 1 3/8 | 1 21/32 | 15/32 | 3/16 | 5/8, 3/4, 7/8, 1 |
| 2AK27 | 2.75 | 2.50 | 2.16 | 1 | 1 3/8 | 1 21/32 | 15/32 | 3/16 | 5/8, 3/4, 7/8, 1 |
| 2AK28 | 2.85 | 2.60 | 2.26 | 1 | 1 3/8 | 1 21/32 | 15/32 | 3/16 | 5/8, 3/4, 7/8, 1 |
| 2AK30 | 3.05 | 2.80 | 2.46 | 1 | 1 3/8 | 1 21/32 | 15/32 | 3/16 | 1/2, 5/8, 3/4, 7/8, 1, 1 1/8 |
| 2AK32 | 3.25 | 3.00 | 2.66 | 1 | 1 3/8 | 1 21/32 | 15/32 | 3/16 | 5/8, 3/4, 7/8, 1, 1 1/8 |
| 2AK34 | 3.45 | 3.20 | 2.86 | 1 | 1 3/8 | 1 21/32 | 15/32 | 3/16 | 5/8, 3/4, 7/8, 1, 1 1/8 |
| 2AK39 | 3.75 | 3.50 | 3.16 | 2 | 1 3/8 | 1 11/32 | 15/32 | 1/2 | 5/8, 3/4, 7/8, 1, 1 1/8 |
| 2AK41 | 3.95 | 3.70 | 3.36 | 2 | 1 3/8 | 1 11/32 | 15/32 | 1/2 | 5/8, 3/4, 7/8, 1, 1 1/8 |
| 2AK44 | 4.25 | 4.00 | 3.66 | 2 | 1 3/8 | 1 11/32 | 15/32 | 1/2 | 5/8, 3/4, 7/8, 1, 1 1/8 |
| 2AK46 | 4.45 | 4.20 | 3.86 | 2 | 1 3/8 | 1 11/32 | 15/32 | 1/2 | 7/8, 1, 1 1/8 |
| 2AK49 | 4.75 | 4.50 | 4.16 | 2 | 1 3/8 | 1 11/32 | 15/32 | 1/2 | 3/4, 7/8, 1, 1 1/8, 1 3/8 |
| 2AK51 | 4.95 | 4.70 | 4.36 | 2 | 1 3/8 | 1 11/32 | 15/32 | 1/2 | 3/4, 7/8, 1, 1 1/8, 1 3/8 |
| 2AK54 | 5.25 | 5.00 | 4.66 | 3 | 1 3/8 | 1 11/32 | 15/32 | 1/2 | 5/8, 3/4, 7/8, 1, 1 1/8, 1 3/8 |
| 2AK56 | 5.45 | 5.20 | 4.86 | 3 | 1 3/8 | 1 11/32 | 15/32 | 1/2 | 5/8, 3/4, 1, 1 1/8, 1 3/8 |
| 2AK59 | 5.75 | 5.50 | 5.16 | 3 | 1 3/8 | 1 11/32 | 15/32 | 1/2 | 1, 1 1/8, 1 3/8 |
| 2AK61 | 5.95 | 5.70 | 5.36 | 3 | 1 3/8 | 1 11/32 | 15/32 | 1/2 | 3/4, 7/8, 1, 1 1/8, 1 3/8 |
| 2AK64 | 6.25 | 6.00 | 5.66 | 3 | 1 3/8 | 1 19/32 | 11/32 | 1/8 | 3/4, 1, 1 1/8, 1 3/16, 1 3/8, 1 7/16 |
| 2AK74 | 7.25 | 7.00 | 6.66 | 3 | 1 3/8 | 1 19/32 | 11/32 | 1/8 | 3/4, 1, 1 1/8, 1 3/16, 1 3/8, 1 7/16 |
| 2AK84 | 8.25 | 8.00 | 7.66 | 3 | 1 3/8 | 1 19/32 | 11/32 | 1/8 | 3/4, 15/16, 1, 1 1/8, 1 3/16, 1 3/8, 1 7/16 |
| 2AK94 | 9.25 | 9.00 | 8.66 | 3 | 1 3/8 | 1 19/32 | 11/32 | 1/8 | 3/4, 1, 1 1/8, 1 3/16, 1 3/8, 1 7/16 |
| 2AK104 | 10.25 | 10.00 | 9.66 | 3 | 1 3/8 | 1 19/32 | 11/32 | 1/8 | 3/4, 15/16, 1, 1 7/16 |
| 2AK114 | 11.25 | 11.00 | 10.66 | 3 | 1 3/8 | 1 19/32 | 11/32 | 1/8 | 3/4, 1, 1 3/16, 1 3/8, 1 7/16 |
| 2AK124 | 12.25 | 12.00 | 11.66 | 3 | 1 3/8 | 1 19/32 | 11/32 | 1/8 | 3/4, 1, 1 3/16, 1 7/16 |
| 2AK134 | 13.25 | 13.00 | 12.66 | 3 | 1 3/8 | 1 19/32 | 11/32 | 1/8 | 1 3/16, 1 7/16 |
| 2AK144 | 14.25 | 14.00 | 13.66 | 3 | 1 3/8 | 1 19/32 | 11/32 | 1/8 | 1, 1 7/16 |
| 2AK154 | 15.25 | 15.00 | 14.66 | 3 | 1 3/8 | 1 19/32 | 11/32 | 1/8 | 1 3/16, 1 7/16 |
| 2AK184 | 18.25 | 18.00 | 17.66 | 3 | 1 3/8 | 1 19/32 | 11/32 | 1/8 | 1 3/16, 1 7/16 |



BORED TO SIZE SHEAVES

直孔皮带轮

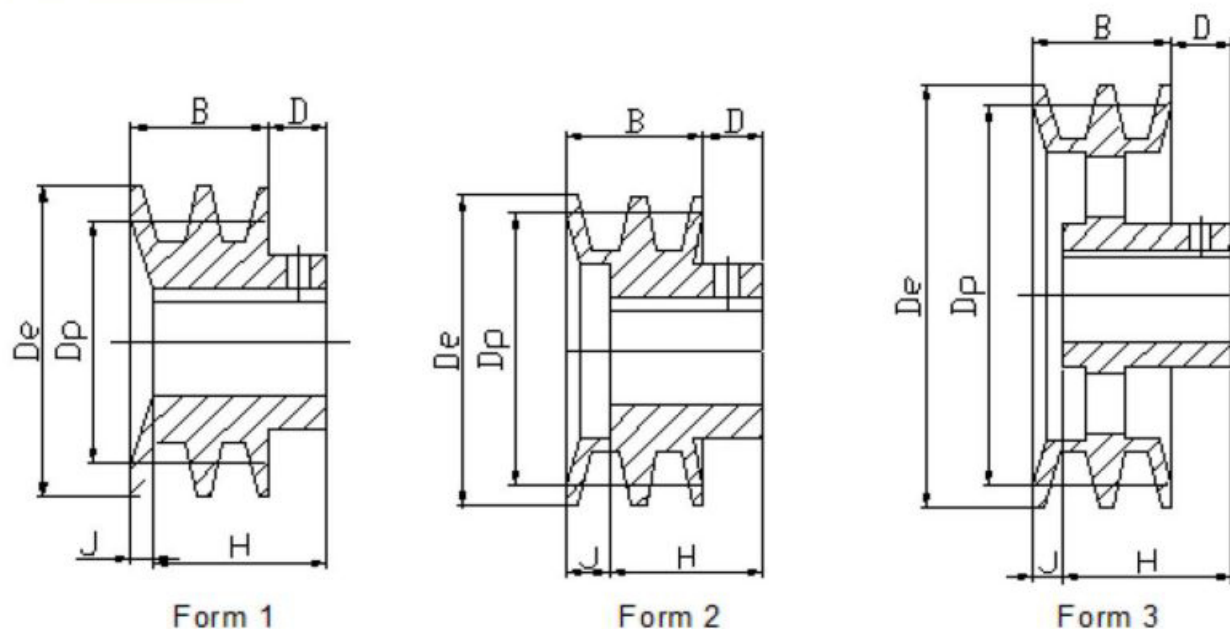

for "4L" or "A" Belts and "5L" or "B" Belts
与"4L", "A"和"5L", "B"型号皮带配合使用

2BK24 TO 2BK190

Table 4

(in)

| SIZE 规格 | Diameter | | | Form 型号 | Dimensions | | | | Stock Bores 孔径 |
|------------|----------|-------|-------|------------|------------|---------|-------|-----|--------------------------------------|
| | De 外径 | Dp 节径 | | | B | H | D | J | |
| | | "A" | "B" | | | | | | |
| 2BK25 | 2.50 | 1.90 | 2.30 | 1 | 1 3/4 | 1 31/32 | 15/32 | 1/4 | 1/2, 5/8, 3/4, 7/8 |
| 2BK27 | 2.70 | 2.10 | 2.50 | 1 | 1 3/4 | 1 31/32 | 15/32 | 1/4 | 1/2, 5/8, 3/4, 7/8, 1 |
| 2BK28 | 2.95 | 2.20 | 2.60 | 1 | 1 3/4 | 1 31/32 | 15/32 | 1/4 | 1/2, 5/8, 3/4, 7/8, 1, 1 1/8 |
| 2BK30 | 3.15 | 2.40 | 2.80 | 1 | 1 3/4 | 1 31/32 | 15/32 | 1/4 | 1/2, 5/8, 3/4, 7/8, 1, 1 1/8 |
| 2BK32 | 3.35 | 2.60 | 3.00 | 1 | 1 3/4 | 1 31/32 | 15/32 | 1/4 | 5/8, 7/8, 1, 1 1/8 |
| 2BK34 | 3.55 | 2.80 | 3.20 | 1 | 1 3/4 | 1 31/32 | 15/32 | 1/4 | 5/8, 3/4, 7/8, 1, 1 1/8 |
| 2BK36 | 3.75 | 3.00 | 3.40 | 1 | 1 3/4 | 1 31/32 | 15/32 | 1/4 | 3/4, 7/8, 1, 1 1/8, 1 3/8 |
| 2BK40 | 3.95 | 3.20 | 3.60 | 2 | 1 3/4 | 1 15/32 | 15/32 | 3/4 | 5/8, 3/4, 7/8, 1, 1 1/8 |
| 2BK45 | 4.25 | 3.50 | 3.90 | 2 | 1 3/4 | 1 15/32 | 15/32 | 3/4 | 1, 1 1/8, 1 3/8 |
| 2BK47 | 4.45 | 3.70 | 4.10 | 2 | 1 3/4 | 1 15/32 | 15/32 | 3/4 | 7/8, 1, 1 1/8 |
| 2BK50 | 4.75 | 4.00 | 4.40 | 2 | 1 3/4 | 1 15/32 | 15/32 | 3/4 | 3/4, 1, 1 1/8, 1 3/8 |
| 2BK52 | 4.95 | 4.20 | 4.60 | 2 | 1 3/4 | 1 15/32 | 15/32 | 3/4 | 7/8, 1, 1 1/8, 1 3/8 |
| 2BK55 | 5.25 | 4.50 | 4.90 | 2 | 1 3/4 | 1 15/32 | 15/32 | 3/4 | 1 1/8, 1 3/8 |
| 2BK57 | 5.45 | 4.70 | 5.10 | 2 | 1 3/4 | 1 15/32 | 15/32 | 3/4 | 1, 1 1/8, 1 3/8 |
| 2BK60 | 5.75 | 5.00 | 5.40 | 3 | 1 3/4 | 1 15/32 | 15/32 | 3/4 | 3/4, 7/8, 1, 1 1/8, 1 3/8 |
| 2BK62 | 5.95 | 5.20 | 5.60 | 3 | 1 3/4 | 1 15/32 | 15/32 | 3/4 | 1, 1 1/8, 1 3/8 |
| 2BK65 | 6.25 | 5.50 | 5.90 | 3 | 1 3/4 | 1 15/32 | 15/32 | 3/4 | 1, 1 1/8, 1 3/8 |
| 2BK67 | 6.45 | 5.70 | 6.10 | 3 | 1 3/4 | 1 15/32 | 15/32 | 3/4 | 1, 1 1/8, 1 3/8 |
| 2BK70 | 6.75 | 6.00 | 6.40 | 3 | 1 3/4 | 1 19/32 | 11/32 | 1/2 | 3/4, 1, 1 1/8, 1 3/16, 1 3/8, 1 7/16 |
| 2BK80 | 7.75 | 7.00 | 7.40 | 3 | 1 3/4 | 1 19/32 | 11/32 | 1/2 | 3/4, 1, 1 1/8, 1 3/16, 1 3/8, 1 7/16 |
| 2BK90 | 8.75 | 8.00 | 8.40 | 3 | 1 3/4 | 1 19/32 | 11/32 | 1/2 | 3/4, 1, 1 1/8, 1 3/16, 1 3/8, 1 7/16 |
| 2BK100 | 9.75 | 9.00 | 9.40 | 3 | 1 3/4 | 1 19/32 | 11/32 | 1/2 | 3/4, 1, 1 3/16, 1 3/8, 1 7/16 |
| 2BK110 | 10.75 | 10.00 | 10.40 | 3 | 1 3/4 | 1 19/32 | 11/32 | 1/2 | 1, 1 3/16, 1 7/16 |
| 2BK120 | 11.75 | 11.00 | 11.40 | 3 | 1 3/4 | 1 19/32 | 11/32 | 1/2 | 1, 1 3/16, 1 7/16 |
| 2BK130 | 12.75 | 12.00 | 12.40 | 3 | 1 3/4 | 1 19/32 | 11/32 | 1/2 | 1, 1 3/16, 1 7/16 |
| 2BK140 | 13.75 | 13.00 | 13.40 | 3 | 1 3/4 | 1 19/32 | 11/32 | 1/2 | 1, 1 3/16, 1 7/16 |
| 2BK160 | 15.75 | 15.00 | 15.40 | 3 | 1 3/4 | 1 19/32 | 11/32 | 1/2 | 1, 1 3/16, 1 7/16 |
| 2BK190 | 18.75 | 18.00 | 18.40 | 3 | 1 3/4 | 1 19/32 | 11/32 | 1/2 | 1 3/16, 1 7/16 |



BORED TO SIZE SHEAVES

直孔皮带轮

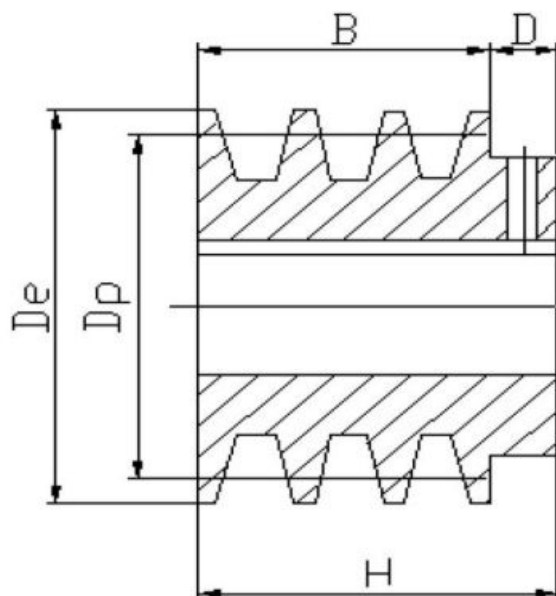

Form 1

for "4L" or "A" Belts and "5L" or "B" Belts
与"4L","A"和"5L","B"型号皮带配合使用

Table 5

3BK25 TO 3BK40

| SIZE 规格 | Diameter | | | Form 型号 | Dimensions | | | | Stock Bores 孔径 |
|------------|----------|-------|------|------------|------------|---|-----|--------------------|-------------------|
| | De 外径 | Dp 节径 | | | B | H | D | J | |
| | | "A" | "B" | | | | | | |
| 3BK25 | 2.50 | 1.90 | 2.30 | 1 | 2 1/2 | 3 | 1/2 | 5/8, 7/8 | |
| 3BK27 | 2.70 | 2.10 | 2.50 | 1 | 2 1/2 | 3 | 1/2 | 5/8, 7/8, 1 | |
| 3BK28 | 2.95 | 2.20 | 2.60 | 1 | 2 1/2 | 3 | 1/2 | 5/8, 7/8, 1, 1 1/8 | |
| 3BK30 | 3.15 | 2.40 | 2.80 | 1 | 2 1/2 | 3 | 1/2 | 7/8, 1, 1 1/8 | |
| 3BK32 | 3.35 | 2.60 | 3.00 | 1 | 2 1/2 | 3 | 1/2 | 7/8, 1, 1 1/8 | |
| 3BK34 | 3.55 | 2.80 | 3.20 | 1 | 2 1/2 | 3 | 1/2 | 7/8, 1, 1 1/8 | |
| 3BK36 | 3.75 | 3.00 | 3.40 | 1 | 2 1/2 | 3 | 1/2 | 7/8, 1, 1 1/8 | |
| 3BK40 | 3.95 | 3.20 | 3.60 | 1 | 2 1/2 | 3 | 1/2 | 7/8, 1, 1 1/8 | |

Table 6 (in.)

| Bore Range 孔径 | Keyseat 键槽 |
|------------------|---------------|
| 1/2 | None |
| 5/8 to 7/8 | 3/16 × 3/32 |
| 5/16 to 1 1/14 | 1/4 × 1/8 |
| 1 7/16 | 3/8 × 3/16 |

NOTE: THIS TABLE 6 IS SUITABLE FOR TABLE 1 TO TABLE 5.