

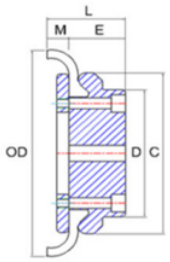

Tyre Coupling

SIZES:F40-F60

SIZES:F70-F250



Pilot Bore (B)

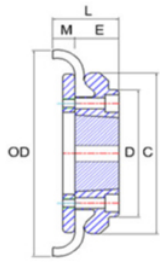

Taper Flange (F)

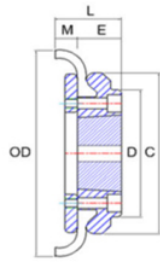

Taper Flange (H)

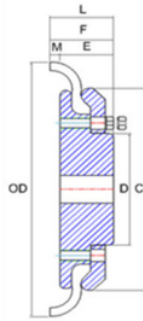

Pilot Bore (B)

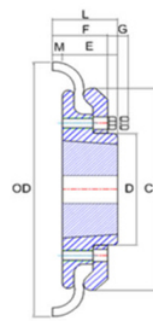

Taper Flange (F)



Taper Flange (H)



Dimensions of Flanges Types B,F & H

Size	Bore	Max Bore		Type B		Types F & H		Key screw for B type	Dimensions					Inertia (kg/m ²)	Material	Approx weight	
		mm	inch	L	E	L	E		OD	C	D	F	G				M
F40B	10mm	32	-	33	22	-	-	M5	104	82	-	-	-	11	0.00074	Steel	0.8
F40F	1008	25	1"	-	-	33	22	-	104	82	-	-	-	11	0.00074	Steel	0.8
F40H	1008	25	1"	-	-	33	22	-	104	82	-	-	-	11	0.00074	Steel	0.8
F50B	10mm	38	-	45	32	-	-	M5	133	100	79	-	-	12.5	0.00115	Steel	1.2
F50F	1210	32	1-1/4"	-	-	38	25	-	133	100	79	-	-	12.5	0.00115	Steel	1.2
F50H	1210	32	1-1/4"	-	-	38	25	-	133	100	79	-	-	12.5	0.00115	Steel	1.2
F60B	10mm	45	-	55	38	-	-	M6	165	125	70	-	-	16.5	0.0052	Steel	2
F60F	1610	42	1-5/8"	-	-	42	25	-	165	125	103	-	-	16.5	0.0052	Steel	2
F60H	1610	42	1-5/8"	-	-	42	25	-	165	125	103	-	-	16.5	0.0052	Steel	2
F70B	20mm	50	-	47	35	-	-	M8	187	144	80	50	13	11.5	0.009	Steel	3.1
F70F	2012	50	2"	-	-	44	32	-	187	144	80	50	13	11.5	0.009	Steel	3.1
F70H	1610	42	1-5/8"	-	-	42	30.5	-	187	144	80	50	13	11.5	0.009	Steel	3
F80B	20mm	60	-	55	42	-	-	M8	211	167	98	54	16	12.5	0.018	Steel	4.9
F80F	2517	60	2-1/2"	-	-	58	45	-	211	167	97	54	16	12.5	0.018	Steel	4.9
F80H	2012	50	2"	-	-	45	32	-	211	167	98	54	16	12.5	0.017	Steel	4.6
F90B	20mm	70	-	64	49	-	-	M10	235	188	112	60	16	13.5	0.032	Steel	7.1
F90F	2517	60	2-1/2"	-	-	59.5	45	-	235	188	108	60	16	13.5	0.031	Steel	7
F90H	2517	60	2-1/2"	-	-	59.5	45	-	235	188	108	60	16	13.5	0.031	Steel	7
F100B	20mm	80	-	71	56	-	-	M10	254	216	125	62	16	13.5	0.055	Steel	9.9
F100F	3020	75	3"	-	-	65.5	51	-	254	216	120	62	16	13.5	0.055	Steel	9.9
F100H	2517	60	2-1/2"	-	-	59.5	45	-	254	216	113	62	16	13.5	0.054	Steel	9.4
F110B	30mm	90	-	76	63	-	-	M12	279	233	128	62	16	12.5	0.081	Steel	12.5
F110F	3020	75	3"	-	-	63.5	51	-	279	233	134	62	16	12.5	0.078	Steel	11.7
F110H	3020	75	3"	-	-	63.5	51	-	279	233	134	62	16	12.5	0.078	Steel	11.7
F120B	30mm	100	-	85	70	-	-	M12	314	264	143	67	16	14.5	0.137	Steel	16.9
F120F	3525	100	4"	-	-	79.5	65	-	314	264	140	67	16	14.5	0.137	Steel	16.5
F120H	3020	75	3"	-	-	65.5	51	-	314	264	140	67	16	14.5	0.13	Steel	15.9
F140B	60mm	130	-	111	94	-	-	M16	359	311	178	73	17	16	0.254	Steel	22.2
F140F	3525	100	4"	-	-	81.5	65	-	359	311	178	73	17	16	0.255	Steel	22.3
F140H	3525	100	4"	-	-	81.5	65	-	359	311	178	73	17	16	0.255	Steel	22.3
F160B	65mm	140	-	117	102	-	-	M16	402	345	187	78	19	15	0.469	Steel	35.8
F160F	4030	115	4-1/2"	-	-	92	76	-	402	345	197	78	19	15	0.38	Steel	32.5
F160H	4030	115	4-1/2"	-	-	92	76	-	402	345	197	78	19	15	0.38	Steel	32.5
F180B	30mm	150	-	137	114	-	-	M16	470	398	200	94	19	23	0.871	Steel	49.1
F180F	4535	125	5"	-	-	112	89	-	470	398	205	94	19	23	0.847	Steel	42.2
F180H	4535	125	5"	-	-	112	89	-	470	398	205	94	19	23	0.847	Steel	42.2
F200B	75mm	150	-	138	114	-	-	M16	508	429	200	103	19	24	1.301	Cast iron	58.2
F200F	4535	125	5"	-	-	113	89	-	508	429	205	103	19	24	1.281	Cast iron	53.6
F200H	4535	125	5"	-	-	113	89	-	508	429	205	103	19	24	1.281	Cast iron	53.6
F220B	80mm	160	-	155	127	-	-	M20	562	474	218	118	20	27.5	2.142	Cast iron	79.6
F220F	5040	125	5"	-	-	130	102	-	562	474	223	118	20	27.5	2.104	Cast iron	72
F220H	5040	125	5"	-	-	130	102	-	562	474	223	118	20	27.5	2.104	Cast iron	72
F250B	90mm	190	-	162	132	-	-	M20	628	532	254	125	25	29.5	3.505	Cast iron	104
F250F	5040	125	5"	-	-	132	102	-	628	448	254	132	25	29.5	3.468	Cast iron	92
F250H	5040	125	5"	-	-	132	102	-	628	448	254	132	25	29.5	3.468	Cast iron	92